

Socket 2P+E, 16A 250V~. Flush

Socket 2P+E, 16A 250V~. Flush graphite colour. With shutter. Without frame. Screw connection.



Features

Common applications	Indoor domestic / tertiary environment (Interior of home, offices, shops, etc.)
Mechanism type	Fixed base
Type of installation	Flush
Rated current	16A
Nominal voltage	250V~ (50/60 Hz)
Connection type	Screw connection
Flexible cable section	Up to 2.5 mm ²
Rigid cable section	Up to 2.5 mm ²
Power	3680W
With fixing claws	Yes

Technical data

Fire resistance (GWEPT)	850 °C
Heat resistance (Ball pressure)	70/125 °C
Free of halogens	Yes

Regulations

CE marking	Yes
According to Regulations UNE/EN	UNE 20315-1-1:2017 UNE 20315-1-2:2017

In accordance with the Low Voltage Electrotechnical Regulations (REBT)	Yes
--	-----

In accordance with the Regulation (EU) 2023/988 of the European Parliament and of the Council on general product safety	Yes
---	-----

Sustainability

According to European Directive 2011/65/UE (RoHS)	Yes
---	-----

According to European Directive 2012/19/UE (RAEE2)	Yes
--	-----

According to Regulations (RoHS)	UNE-EN IEC 63000:2022
---------------------------------	-----------------------

Logistics and packaging

Unit EAN code	8423220221222
---------------	---------------

EAN code container	8423220220935
--------------------	---------------

EAN code packaging	18423220220932
--------------------	----------------

Units packaging	10
-----------------	----

Units carton	120
--------------	-----

Pallet Units	4320
--------------	------

Packaging Measurements cm	26x14x10
---------------------------	----------

Packaging Measures cm	44x27,5x40
-----------------------	------------

Unit weight (g)	18,2
-----------------	------

Container Weight (Kg)	0,3324
-----------------------	--------

Packaging Weight (Kg)	4,7068
-----------------------	--------

Tariff code	85366990
-------------	----------

Sketch

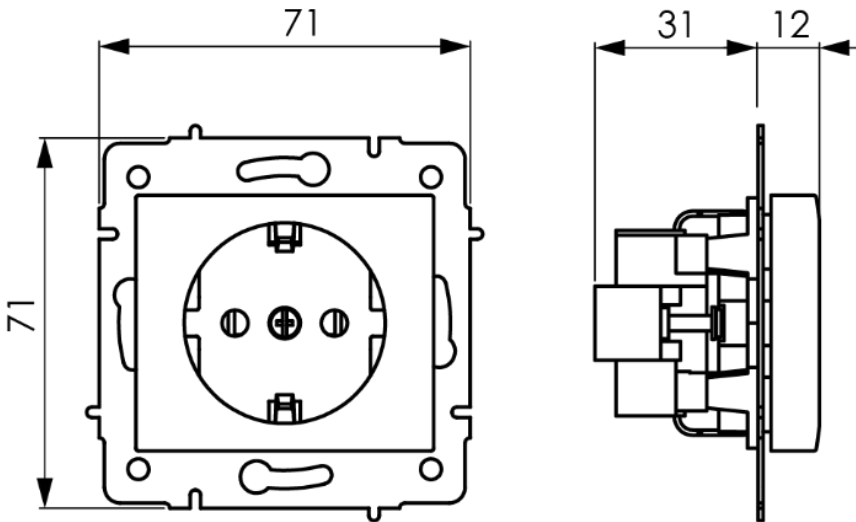

Documentation and downloads



Commercial doc. (3.28MB)



Safety Information (0.38MB)



Flush switches of Eruopa range (Solera)



Assembly flush switches form Europa range (Solera)