

Surface connection box. Ø 93.5 mm. Round cover threaded.

Surface connection box. Ø 93.5 mm. Round cover threaded. Height 35,5 mm.
With 4 inputs for tube Ø 20 and 4 inputs for tube Ø 18 mm.



Features

Installation method	Flush in work
Use	Domestic / Tertiary
Location type	Inside
Dimensions outside (mm) (width x height x depth)	Ø 93,5x35,5
Case material	Insulation
Case color	Grey (RAL7035)
Door color	Grey (RAL7035)
No. of inlets and size (mm)	4x Ø 20 y 4xØ 18
Fixation System (For surface)	Inside
Lid closure system	Threaded
Common applications	Indoor domestic / tertiary environment (Interior of home, offices, shops, etc.)

Technical data

Insulation class	Class II
Fire resistance (GWEPT)	650 °C
Ambient operating temperature	-5 °C ; +60 °C
Work stress	400 Vac
Free of halogens	Yes

Regulations

CE marking	Yes
UK marking	Yes
CMim marking	Yes
According to Regulations UNE/EN	UNE-EN 60670-1:2022 UNE- EN 60670-22:2007
In accordance with the Low Voltage Electrotechnical Regulations (REBT)	Yes
According to European Directive 2014/35 / EU. Low voltage directive	Yes

Sustainability

According to European Directive 2011/65/UE (RoHS)	The Directive 2011/65/EU (RoHS II) is not applicable as it does not correspond to the definition of Electrical and Electronical Equipment (EEE) as per article 3.1
According to European Directive 2012/19/UE (RAEE2)	Not applicable because it does not meet the definition of Electrical and Electronic Equipment (EEE) as described in Article 3.1(a) of Directive 2012/19/EU (WEEE II).

Logistics and packaging

Unit EAN code	8423220140219
EAN code container	8423220140219
EAN code packaging	18423220140216
Units packaging	1
Units carton	400
Pallet Units	4800
Packaging Measures cm	59,5x39,5x64
Unit weight (g)	37,6
Container Weight (Kg)	0,0476
Packaging Weight (Kg)	20,29
Tariff code	85371098

Sketch

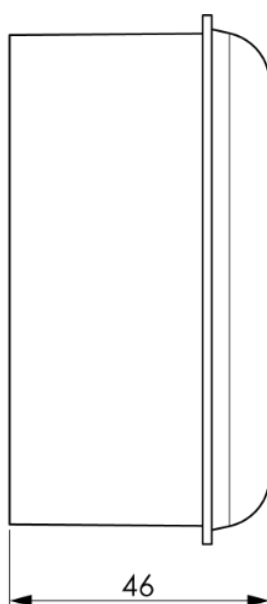
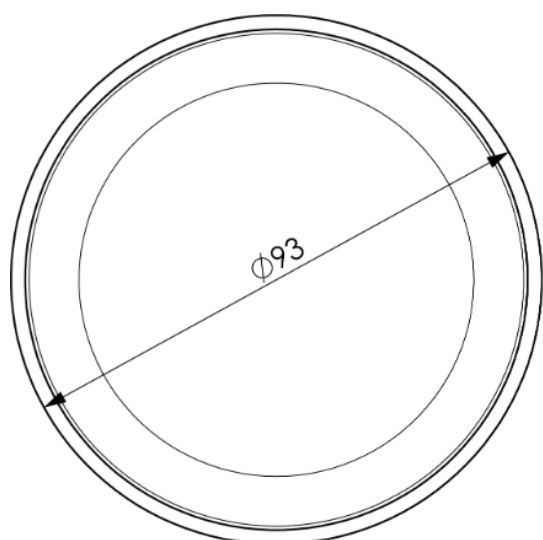

Documentation and downloads



[Assembly instructions \(0.59MB\)](#)



[Safety Information \(0.38MB\)](#)