

## Surface distribution board, 14 modules.

Surface-mounted distribution board for 14 modules. Finished in white and equipped with a key lock for added security. Suitable for small exposed installations. External dimensions: 362 x 250 x 104 mm. Sealable model.



### Features

Installation method	Surface
Use	Domestic / Tertiary
Location type	Inside
No. Modules (18 mm)	14
Modules per row	14
Metallic DIN profile	Yes
Dimensions outside (mm) (width x height x depth)	362x250x104
Dimensions (mm)	See sketch
Case material	Insulation
Frame and door material	Insulation
Case color	White
Cap color	White
Door color	White
Door opening	Horizontal
Battens included	No
Ticket type	Pre-punched
Fixation System (For surface)	Inside
Sealable	Yes
Lid closure system	Metal screw
Door closing system	A Pressure
Reversible door	Yes

Possibility of mounting strips	Yes (not included)
Possibility of putting lock	Key included
Separate covers or doors on the boxes	Yes
Possibility of mounting DIN rail	Yes (included)
Common applications	Indoor domestic / tertiary environment (Interior of home, offices, shops, etc.)
Additional dimensions (mm)	See sketch

## Technical data

Protection Degree (IK)	IK08
Insulation class	Class II
Fire resistance (GWEPT)	650 °C
Heat resistance (Ball pressure)	70 °C
Installation temperature	-5 °C -> +60 °C
Ambient operating temperature	-5 °C ; +60 °C
Work stress	<1000 Vac ; 1500 Vdc
Thermal power dissipated	40 W
Free of halogens	Yes

## Regulations

CE marking	Yes
UK marking	Yes
CMim marking	Yes
According to Regulations UNE/EN	UNE-EN 62208:2012
In accordance with the Low Voltage Electrotechnical Regulations (REBT)	Yes
According to European Directive 2014/35 / EU. Low voltage directive	Yes

## Sustainability

According to European Directive 2011/65/EU (RoHS)	The Directive 2011/65/EU (RoHS II) is not applicable as it does not correspond to the definition of Electrical and Electronical Equipment (EEE) as per article 3.1
---	--

According to European Directive 2012/19/UE (RAEE2)

Not applicable because it does not meet the definition of Electrical and Electronic Equipment (EEE) as described in Article 3.1(a) of Directive 2012/19/EU (WEEE II).

## Logistics and packaging

Unit EAN code	8423220055995
EAN code container	8423220055995
Units packaging	1
Units carton	9
Pallet Units	135
Packaging Measurements cm	36,5x25x10,5
Packaging Measures cm	59,5x39,5x48
Unit weight (g)	1215
Container Weight (Kg)	1,376
Packaging Weight (Kg)	13,434
Tariff code	85371098

## Sketch

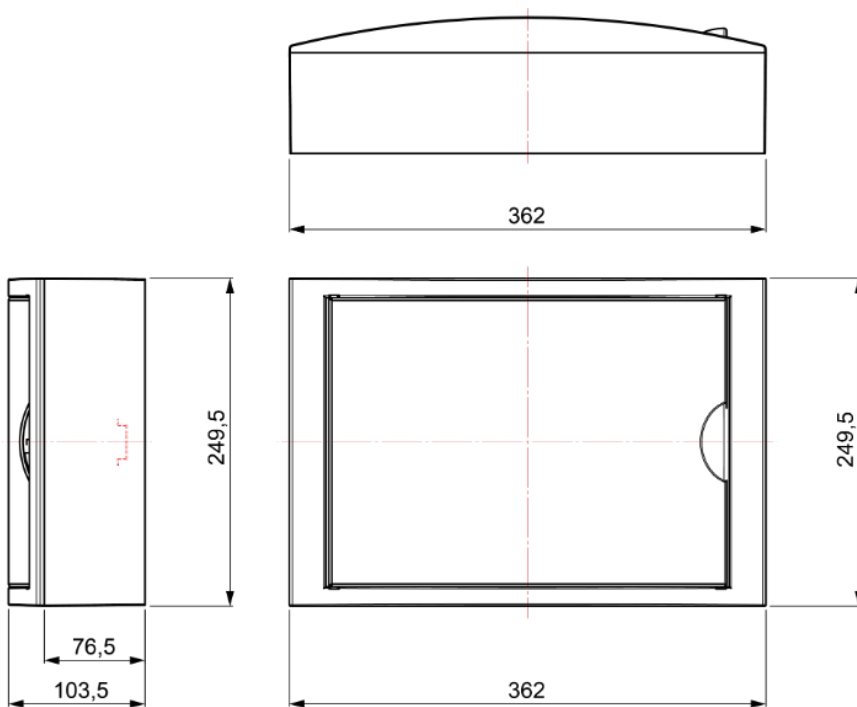

## Documentation and downloads



Assembly instructions (2.09MB)



Safety Information (0.38MB)



Series replenishments (0.12MB)



Mounting distribution boards. Arelos range (Solera)



Included accessories (0.09MB)



Dimensions table (0.15MB)



Distribution boards Arelos range (Solera) (Ed. 2024)