

## Flush distribution board, 4 modules.

Flush-mounted board with 4 modules. White frame and door. Dimensions 140 x 270 x 72 mm. Compact size for small modular assemblies or point installations.



## Features

Installation method	Flush in work
Use	Domestic / Tertiary
Location type	Inside
No. Modules (18 mm)	4
Modules per row	4
Metallic DIN profile	Yes
Dimensions gap (mm) (Width x Height x Depth)	140x270x72
Dimensions (mm)	See sketch
Case material	Insulation
Frame and door material	Insulation
Case color	Black
Cap color	White
Door color	White
Door opening	Vertical
Battens included	No
Ticket type	Unfathomable
Fixation System (For surface)	Inside
Sealable	Sealable compartment
Lid closure system	Metal screw

Door closing system	A Pressure
Reversible door	Yes
Separate covers or doors on the boxes	Yes
Possibility of mounting DIN rail	Yes (included)
Captive screw	Yes
Common applications	Indoor domestic / tertiary environment (Interior of home, offices, shops, etc.)
Additional dimensions (mm)	See sketch

## Technical data

Protection Degree (IK)	IK08
Insulation class	Class II
Fire resistance (GWEPT)	650 °C
Heat resistance (Ball pressure)	70 °C
Installation temperature	-5 °C -> +60 °C
Ambient operating temperature	-5 °C ; +60 °C
Work stress	400 Vac-1000 Vdc
Free of halogens	Yes

## Regulations

CE marking	Yes
UK marking	Yes
CMim marking	Yes
According to Regulations UNE/EN	UNE-EN 62208:2012
In accordance with the Low Voltage Electrotechnical Regulations (REBT)	Yes
According to European Directive 2014/35 / EU. Low voltage directive	Yes

## Sustainability

According to European Directive 2011/65/EU (RoHS)	The Directive 2011/65/EU (RoHS II) is not applicable as it does not correspond to the definition of Electrical and Electronical Equipment (EEE) as per article 3.1
---	--

According to European Directive 2012/19/UE (RAEE2)

Not applicable because it does not meet the definition of Electrical and Electronic Equipment (EEE) as described in Article 3.1(a) of Directive 2012/19/EU (WEEE II).

## Logistics and packaging

Unit EAN code	8423220011212
EAN code container	8423220011212
EAN code packaging	18423220011219
Units packaging	1
Units carton	22
Pallet Units	264
Packaging Measurements cm	9,5x16,5x30
Packaging Measures cm	59,5x42,5x51
Unit weight (g)	570
Container Weight (Kg)	0,6674
Packaging Weight (Kg)	15,6068
Tariff code	85371098



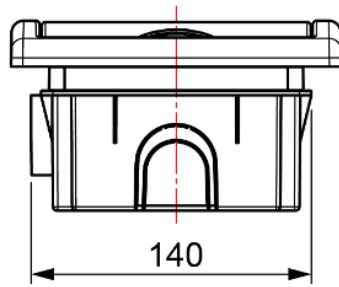

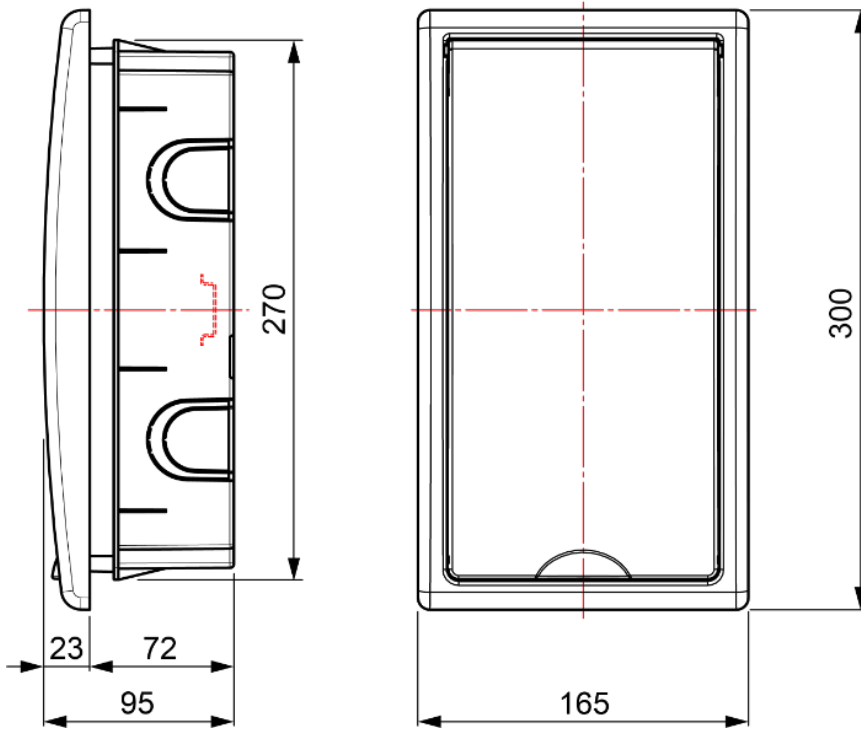

## Sketch



Altura del marco = 23mm



## Documentation and downloads

- |  |  |   |  |
|--|--|---|--|
|  | <a href="#">Assembly instructions (2.09MB)</a>                       |  | <a href="#">Included accessories (0.14MB)</a>        |
|  | <a href="#">Safety Information (0.38MB)</a>                          |  | <a href="#">Link options for enclosures (0.13MB)</a> |
|  | <a href="#">Dimensions table (0.15MB)</a>                            |  | <a href="#">Series replenishments (0.04MB)</a>       |
|  | <a href="#">Distribution boards Arelos range (Solera) (Ed. 2024)</a> |   |  |