

## Time switch 24 h. Analogue.

The 24-hour analog time switch allows scheduling of installation on/off cycles. It operates at 230V~, fits three modules and features ON-OFF-Timer function. It includes a 150-hour reserve and a 15-minute minimum time unit. It has a 1NOC contact (16A). Common applications in indoor residential or tertiary environments such as homes, offices or shops.



## Features

Common applications	Indoor domestic / tertiary environment (Interior of home, offices, shops, etc.)
Modular device type	Daily schedule programmer
No. of poles	1P + N
Modules (18 mm)	3
Network type	Alternating current (ac)
Fixation	35mm DIN rail
Reservation	150 hours
Contacts	1NO + 1NC
Minimum unit of time that measures	15 minutes
Nominal current	16A
Nominal voltage	230 Vca - (50/60 Hz)

## Technical data

Fire resistance (GWEPT)	960 °C
Ambient operating temperature	-5 °C ; +40 °C
Free of halogens	Yes

## Regulations

CE marking	Yes
UK marking	Yes
CMim marking	Yes
According to Regulations UNE/EN	UNE-EN 60730-2-7:2020
In accordance with the Low Voltage Electrotechnical Regulations (REBT)	Yes
According to European Directive 2014/35 / EU. Low voltage directive	Yes

## Sustainability

According to European Directive 2011/65/UE (RoHS)	Yes
According to European Directive 2012/19/UE (RAEE2)	Yes
According to Regulations (RoHS)	UNE-EN IEC 63000:2022

## Logistics and packaging

Unit EAN code	8423220081222
EAN code container	8423220066281
EAN code packaging	18423220066288
Units packaging	4
Units carton	40
Pallet Units	2000
Packaging Measurements cm	10,5x6x8
Packaging Measures cm	44x43,5x39
Unit weight (g)	157
Container Weight (Kg)	0,1898
Packaging Weight (Kg)	7,323
Tariff code	85362010

## Sketch

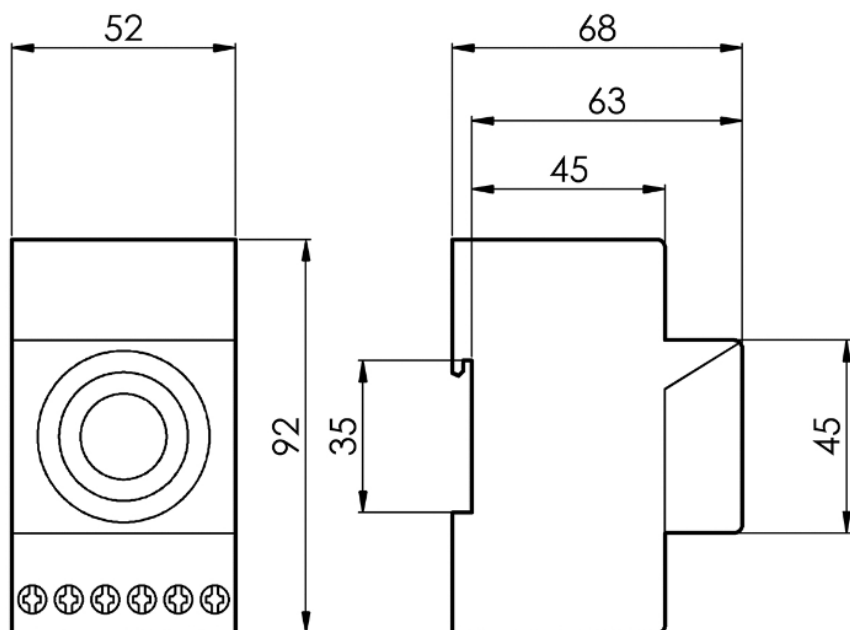

## Documentation and downloads



Safety Information (0.38MB)