

## 5 Mounting (2/2): (SEE "DESCRIPTION AND COMPONENTS" POINT-3-).

### 13 PRE-CUT HOLES FOR LINKING

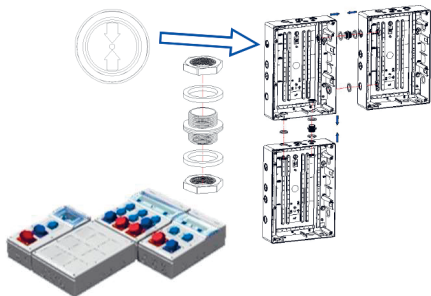

### 15 DOOR

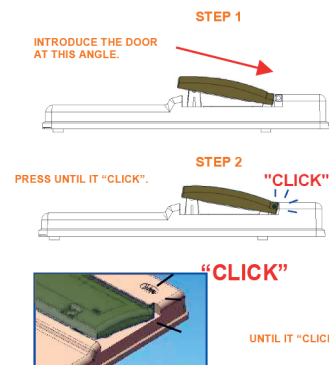

## 6 Technical information:

-Temperature limit for storage, transport and installation.

PS

PC



## 7 Product maintenance:

-Wipe the surface of the boxes with a damp cloth.

### 8



Safety and usage tips.

## 9 Terminal bars:

Item No.	A	B	C	D
1303/W	✓	✗	✗	✗
1304R/W	✗	✓	✗	✗
1306BR/W	✗	✓	✗	✗
1308AR/W	✗	✗	✓	✗
1308BR/W	✗	✗	✓	✗
1312R/W	✗	✗	✓	✗
1322R/W	✗	✗	✗	✓
1332P-W	✗	✗	✗	✓
1336R/W	✗	✗	✗	✓
1348R/W	✗	✗	✗	✓

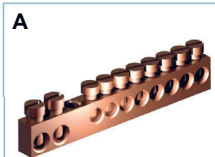

Brass Earth Bar with 1303/W



1304 R/W, 1306 BR/W

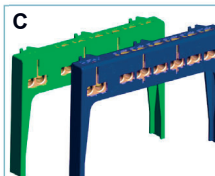

1308 BR/W, 1308 AR/W,  
1312 R/W

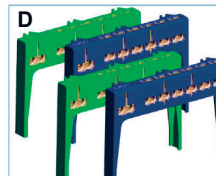

1322 R/W, 1332P-W,  
1336 R/W, 1348 R/W

## IP65 INDUSTRIAL DISTRIBUTION BOXES

**1303/W; 1304R/W; 1304RL/W;  
1306BR/W; 1308BR/W;  
1308AR/W; 1312R/W; 1322R/W;  
1336R/W; 1348R/W; 820W;  
820PL/W; 821W; 821PL/W**

## 1 General view:

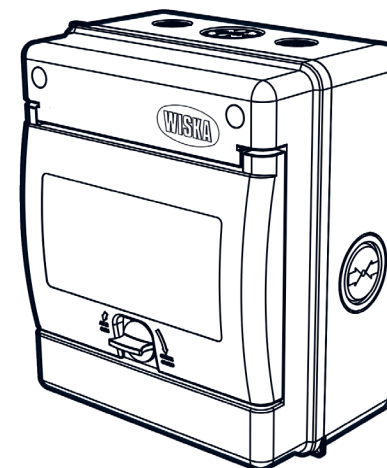

## 2 Normative:

**These enclosures are manufactured and designed to be acceptable to take all the commercially available devices in line with BSEN 60898.**

-Follow these instructions to comply with the R.D. 842/2002, directive 2014/35/UE (DBT) and EN 62208.

-Installation, service and maintenance of the electrical equipment may be carried out by an authorized person only.

### 3 Description and components:

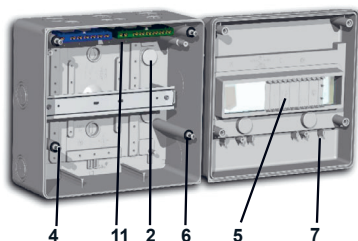

Surface installation.

- 1- Multi-positioning cable grip.
- 2- Internal wall fixing holes, including cap for screws in order to maintain protection class II (see detail explanation).
- 3- Hinges for connecting box and lid with 4 positions, allowing opening from right, left or below (see detail explanation).
- 4- Closure with fast self tapping stainless steel screws with embellishing cap.
- 5- Blind cover.
- 6- Closing sealant joint.
- 7- Lids prepared for mounting earth and neutral bars.
- 8- Reinforced plain or window lids for mounting any socket varieties available in the market.
- 9- External wall bracket with corner support offering triple angle positioning ensuring IP (see detail explanation).

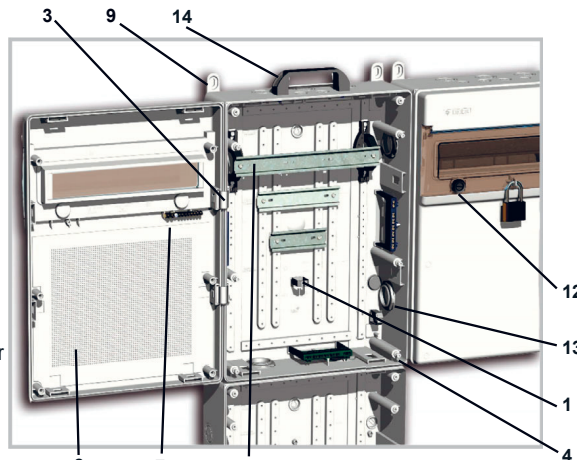

- 10- Positioning holes allowing fixings of rails at the top, bottom and back.
- 11- Box prepared for mounting earth and neutral bars.
- 12- Locks for the doors (see detail explanation).
- 13- Pre-cut holes for linking cable glands (see detail explanation).
- 14- Handle.
- 15- Door mounting (see detail explanation).

(SEE INSTRUCTIONS IN POINT-5)

### 4 Indubox content list (1/2):

	PACKING LIST						BOX			
	1	2	3	4	5	6	*Pre-cut holes			
	CABLE GRIP	CAPS	SCREW	HINGES	BLIND COVER	KIT-6A	Up / Down			
	REF. KIT1300SUJ	REF. TPO1300/4 TPO1300/6	REF. .T-1300	REF. BIS1300	REF. 1300GTA /100G	REF. KIT-6A	M20-Pg11	M25 Pg16	M32 Pg21	M32-Pg21
1303W	0	1	4	0	1	1	0	0	2	0
1304R/W	0	1	4	0	1	1	0	0	2	2
1304RLW	0	1	4	0	1	1	0	0	2	2
1306BR/W	0	1	4	0	1	1	4	0	2	2
1308BR/W	0	1	4	0	1	1	4	4	2	2
1308AR/W	0	1	4	0	1	1	4	4	2	2
1311AR/W	0	1	4	0	1	1	4	4	6	4
1312R/W	0	1	4	0	1	1	4	4	6	4
1312ROYAL	0	1	4	0	1	1	4	4	6	4
1322R-W	2	1	6	0	1	1	4	4	6	4
1336R/W	0	1	6	2	1	1	4	4	6	4
1348R/W	4	1	6	2	1	1	4	4	6	8
820W	0	1	6	2	0	1	4	4	6	8
820PL-W	0	1	6	2	0	1	4	4	6	8
821W	0	1	6	2	0	1	4	4	6	8
821PL-W	0	1	6	2	0	1	4	4	6	8

### 4 (2/2): (\*SEE TABLE OF THE POINT 4 "Pre-cut holes").

Type	For Metric use	For Pg use	For Ø use
M20-Pg21			
Pg16			
M32-Pg21			

Cut red for indicated measure

### 5 Mounting (1/2): (SEE "DESCRIPTION AND COMPONENTS" POINT-3).

#### 2 INTERNAL WALL FIXING

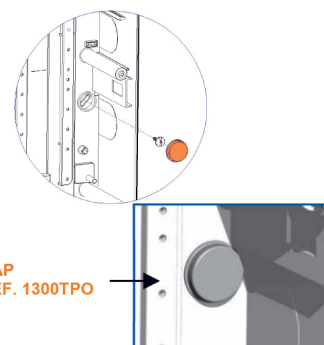

#### 3 HINGE

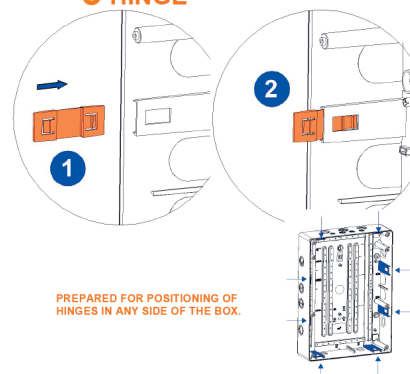

#### 9 EXTERNAL WALL FIXING BRACKETS

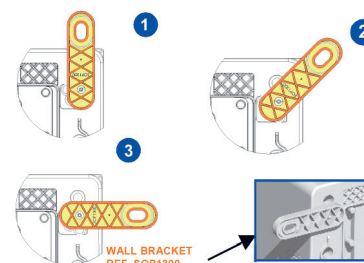

#### 12 LOCKS

